

20120-01-001

**Proposed Wind Farm at
Castlebanny, Co. Kilkenny**

ROAD SAFETY AUDIT STAGE 1 / 2

December 2020

ROADPLAN

CONSULTING

7, Ormonde Road
Kilkenny
R95 N4FE

Tel: 056 7795800
info@roadplan.ie

1. INTRODUCTION

- 1.1 This report describes a Stage 1/2 Road Safety Audit carried out on a proposed wind farm at Castlebanny, Co. Kilkenny on behalf of Tobin Consulting Engineers. The audit was carried out on 23rd November 2020 in the offices of Roadplan Consulting, Kilkenny.
- 1.2 The audit team members were as follows:
- George Frisby, BE CEng MIEI
Auditor Number GF51255
 - Richard Frisby, BSc AEng MIEI
Auditor Number RF1337391
- 1.3 Both audit team members visited the site on the 02nd November 2020. The audit comprised an examination of the drawings relating to the scheme supplied by Tobin Consulting Engineers and an examination of the site.
- 1.4 An examination of the RSA collision database shows that there have been one serious collision within close proximity to the location of the proposed access to the wind farm from the R704 in the period of 2005 to 2016 inclusive. The collision is recorded as a single vehicle collision. The location of the collision is shown in Figure 1 below:

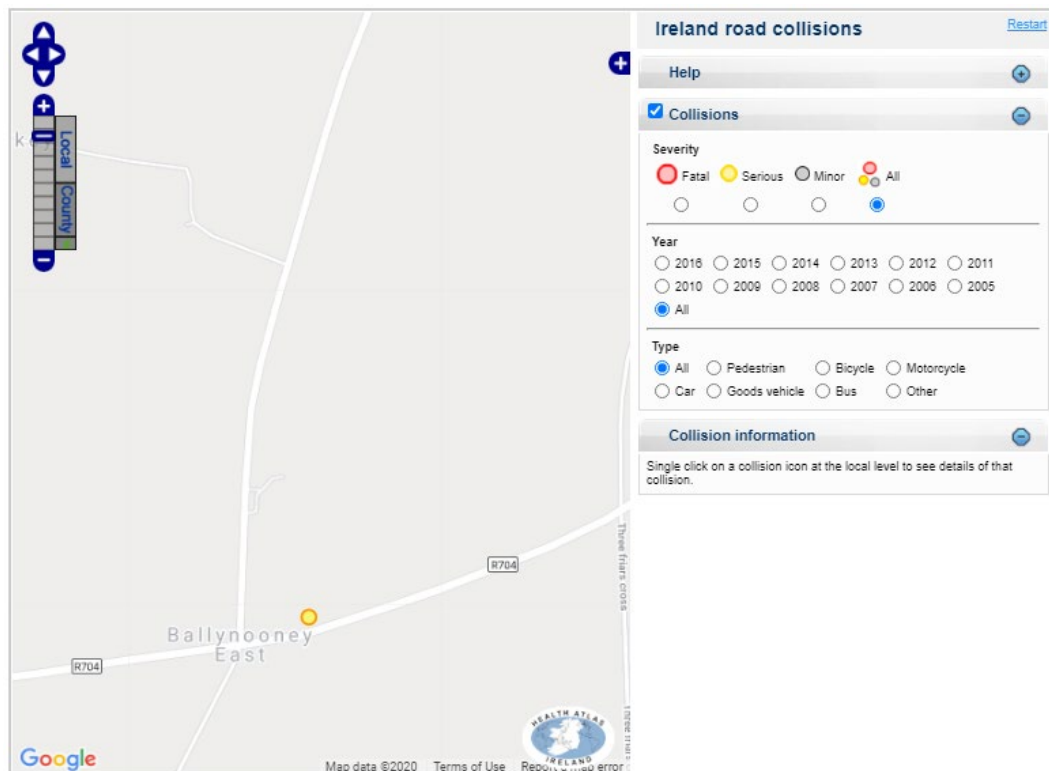

Figure 1: Road Collisions

- 1.5 This Stage 1/2 Audit has been carried out in accordance with the relevant sections of TII GE-STY-01024. The team has examined only those issues

within the design relating to the road safety implications of the scheme and has therefore not examined or verified the compliance of the design to any other criteria.

- 1.6 All of the problems described in this report are considered by the audit team to require action in order to improve the safety of the scheme and minimise accident occurrence.
- 1.7 Appendix A lists the audited drawings.

2. STAGE 1 / 2 AUDIT

2.1 Problem.

There is an existing dip in the vertical alignment located on the western side of the R704 carriageway. Visibility splays at the proposed access to the wind farm may be restricted by the vertical alignment of the R704 regional road. A lack of adequate visibility at the proposed access may contribute to a side impact collision at the access.



Recommendation

Ensure adequate horizontal and vertical visibility splays are provided at the proposed access onto the R704 regional road.

2.2 Problem.

The swept path analysis at the proposed access to the wind farm suggests that the access cannot adequately cater for a HGV entering and exiting the development at the same time. A delay in a HGV turning into the development from the R704 may lead to a rear-end collision.

Recommendation

Ensure the proposed access can adequately cater for HGV's entering and exiting the site access simultaneously.

2.3 Problem.

At the proposed crossing point located on the local road the proposed internal access road is approximately 5m wide. The proposed width may not adequately cater for opposing HGV's passing one another at the

access points. A delay in a HGV entering the access points may lead to a side impact collision with a vehicle on the mainline.

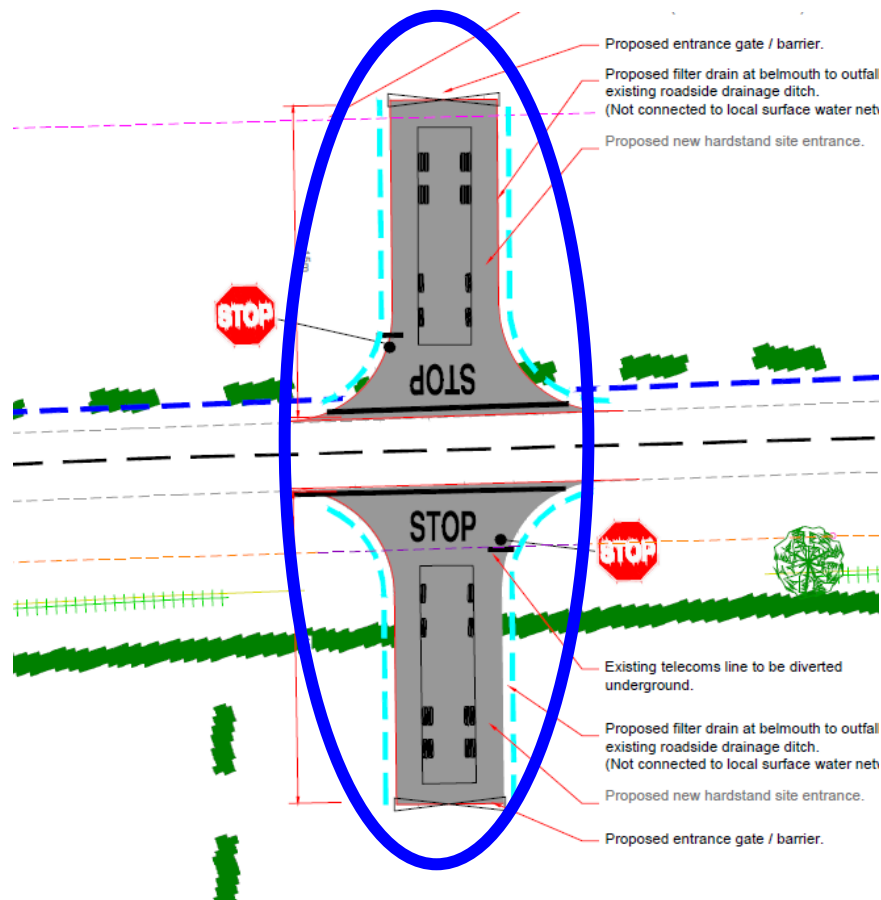

Recommendation

Ensure adequate width is provided at the access points to cater for opposing HGV's to pass one another.

2.4 Problem.

Hazard warning signs are provided on the approaches to the site access on the R704 and the site crossing point on the local road. However, no supplementary plate is provided to inform motorist of the nature of the hazard. In addition, the directional supplementary distance plates provided on the approach to the crossing point on the local road indicates one directional arrow only (left arrow) instead of two.

Recommendation

Provide a supplementary plate to inform motorist of the nature of the hazard and ensure two arrows (left & right) are provided on the directional supplementary distance plate provided on the approach to the crossing point on the local road.

3. AUDIT TEAM STATEMENT

3.1 We certify that we have examined the drawing listed in Appendix A and have inspected the site. This examination has been carried out with the sole purpose of identifying any features of the design that could be removed or modified to improve the safety of the scheme.

Signed.....  George Frisby

Date25th November 2020.....

Signed.....  Richard Frisby

Date 25th November 2020.....

APPENDIX A

List of Drawings Examined

The following drawing numbered have been provided electronically in PDF format by Tobin Consulting Engineers.

Drawing number	Rev	Drawing title
10730-2050	D01	Site Entrance Visibility Sightlines R704
10730-2051	D01	Site Entrance Visibility Sightlines L7451
10730-2052	D01	Site Entrance Improvement Works & Autotrack Assessment R704
10730-2053	D01	Site Entrance Improvement Works L7451

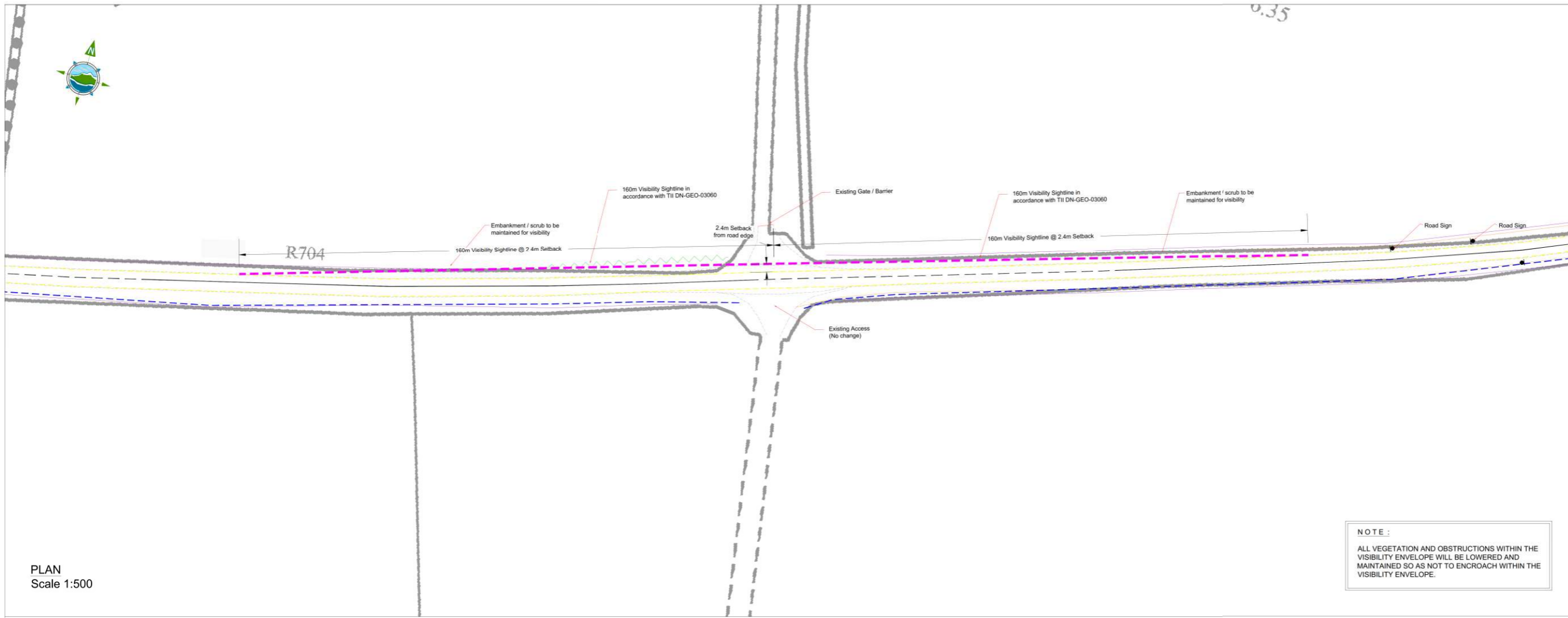

PLAN
Scale 1:500

NOTE :
ALL VEGETATION AND OBSTRUCTIONS WITHIN THE VISIBILITY ENVELOPE WILL BE LOWERED AND MAINTAINED SO AS NOT TO ENCRDACH WITHIN THE VISIBILITY ENVELOPE.

- Plan Legend:**
- Visibility Sightline ---
 - Existing Road Edge ---
 - Existing Drain ---
 - Road Centerline ---
 - Road Edge Line ---
 - Road Verge ---
 - Top of Embankment ---
 - Existing Hedgerow ---
 - Existing Tree / Bush
 - Existing Road Sign ●
- Section Legend:**
- Visibility Envelope ---
 - Existing Ground Level ---
 - 0.26m Sightline ---
 - Existing Road Edge ---

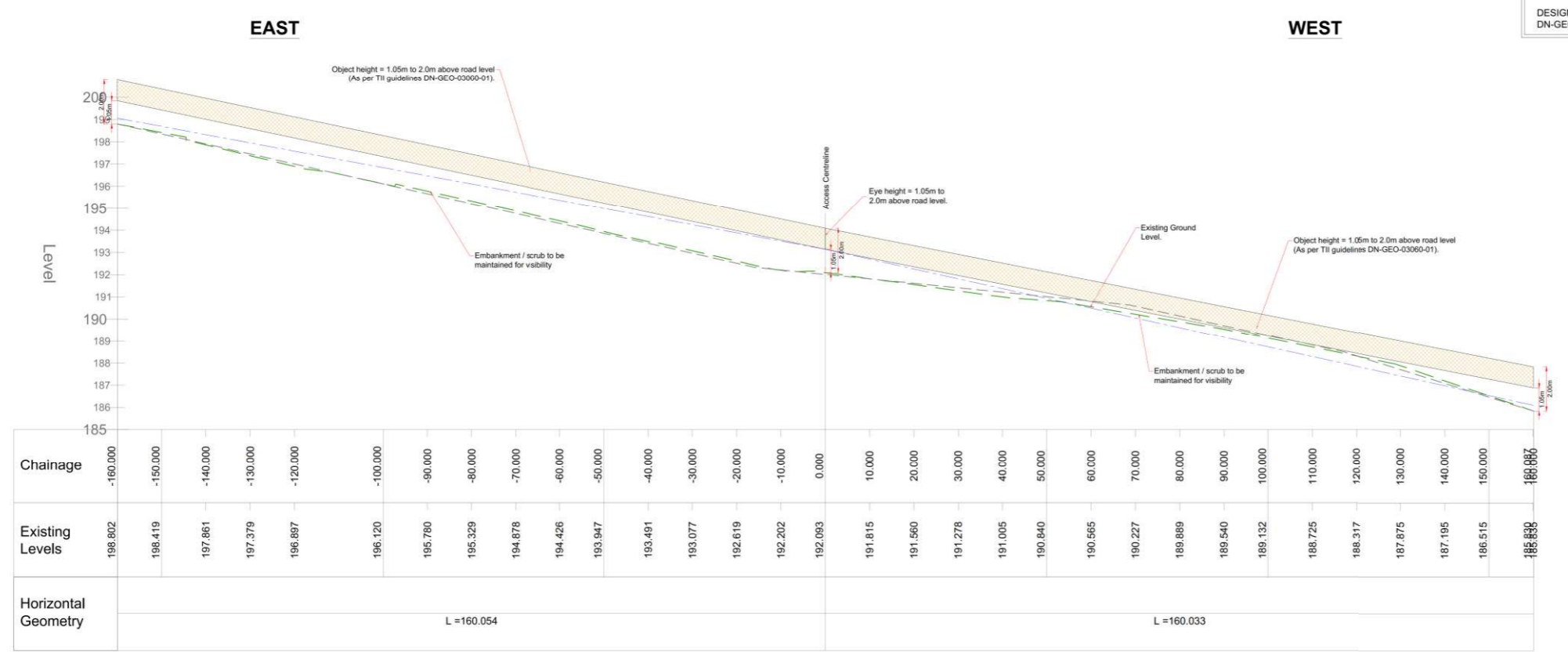

NOTE :
DESIGNED IN ACCORDANCE WITH TII GUIDANCE DN-GEO-03060 (June 2017).

CB_1-1 - LONGSECTION
SCALE: H 1:500, V 1:100. DATUM: 185.000

Rev	Date	Description	By	Chkd.
D01	13.11.20	DRAFT ISSUE FOR REVIEW	MN	JS

Client:

Project: CASTLEBANNY WIND FARM

Title: SITE ENTRANCE VISIBILITY SIGHTLINES R704

Scale @ A1: As Shown

Prepared by: M. Nolan
Checked: J. Staunton
June 2020

Project Director:
Drawing Status: Information

TOBIN
CONSULTING ENGINEERS

Block 10-4, Blanchardstown Corporate Park,
Dublin 15, Ireland.
tel: +353-(0)1-8030406
fax: +353-(0)1-8030409
e-mail: dublin@tobin.ie
www.tobin.ie

Tobin Consulting Engineers will not be liable for any use of this document for any purpose other than that for which it was originally prepared and provided. Except where specifically and explicitly agreed in writing by Tobin Consulting Engineers, no copyright holder, no part of this document may be reproduced or transmitted in any form and this document shall not be relied upon by any third party for any purpose.

Drawing No.: 10730-2050 D01

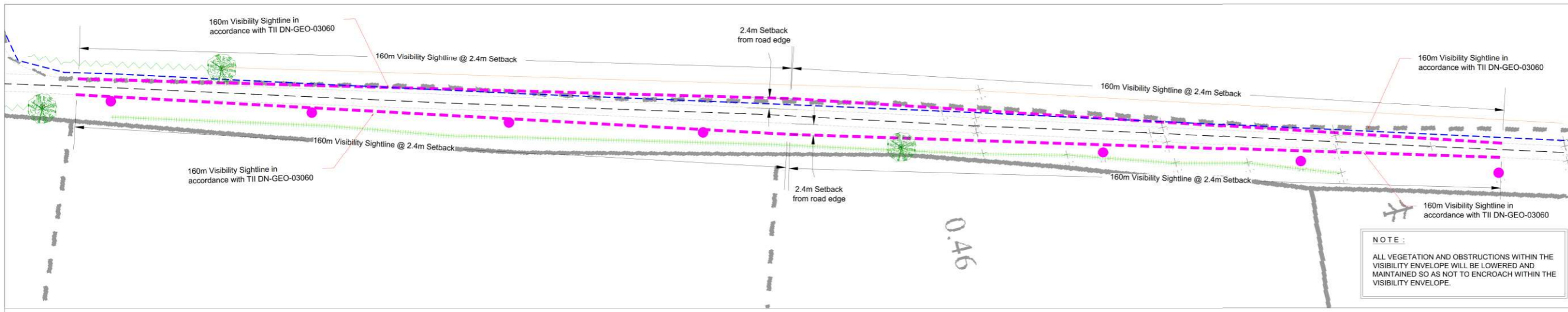

- Plan Legend:**
- Visibility Sightline
 - Existing Road Edge
 - Existing Drain
 - Road Centerline
 - Road Verge
 - Treeline
 - Existing Hedgerow
 - Existing Tree / Bush
 - Existing ESB Pole
- Section Legend:**
- Visibility Envelope
 - Existing Ground Level
 - 0.26m Sightline

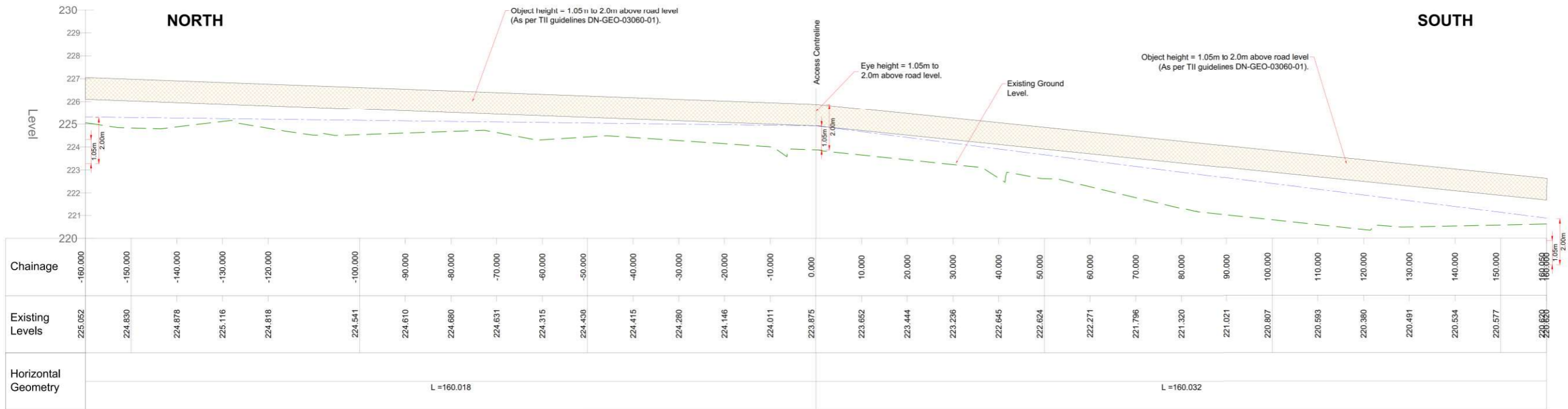

EGRESS - LONGSECTION
SCALE: H 1:500, V 1:100. DATUM: 220.000

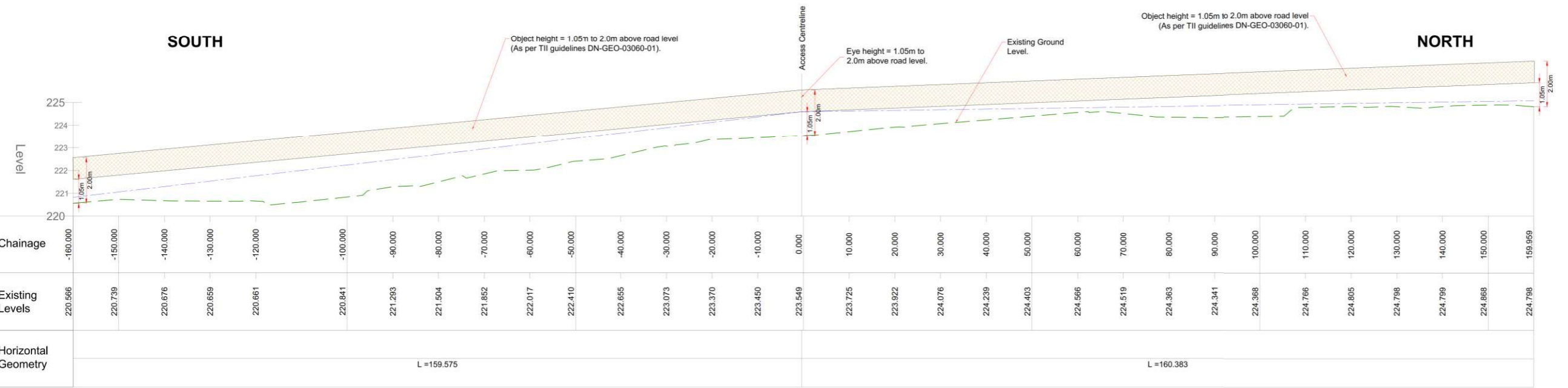

ACCESS - LONGSECTION
SCALE: H 1:500, V 1:100. DATUM: 220.000

NOTE:
DESIGNED IN ACCORDANCE WITH TII GUIDANCE
DN-GEO-03060 (June 2017).

Rev	Date	Description	By	Chkd.

Client: **COILLTE**

Project: **CASTLEBANNY WIND FARM**

Title: **SITE ENTRANCE VISIBILITY SIGHTLINES L7451**

Scale @ A1: **As Shown**

Prepared by: **M. Nolan** | Checked: **J. Staunton** | **June 2020**

Project Director: **J. Staunton**

Drawing Status: **Information**

TOBIN
CONSULTING ENGINEERS

Block 10-4, Blanchardstown Corporate Park,
Dublin 15, Ireland.
tel: +353-(0)1-8030406
fax: +353-(0)1-8030409
e-mail: dublin@tobin.ie
www.tobin.ie

TOBIN Consulting Engineers will not be liable for any use of this document for any purpose other than that for which it was originally prepared and provided. Except where specifically and explicitly agreed in writing by TOBIN Consulting Engineers, no copyright holder, no part of this document may be reproduced or transmitted in any form and this document shall not be relied upon by any third party for any purpose.

Drawing No.: **10730-2051 D01**

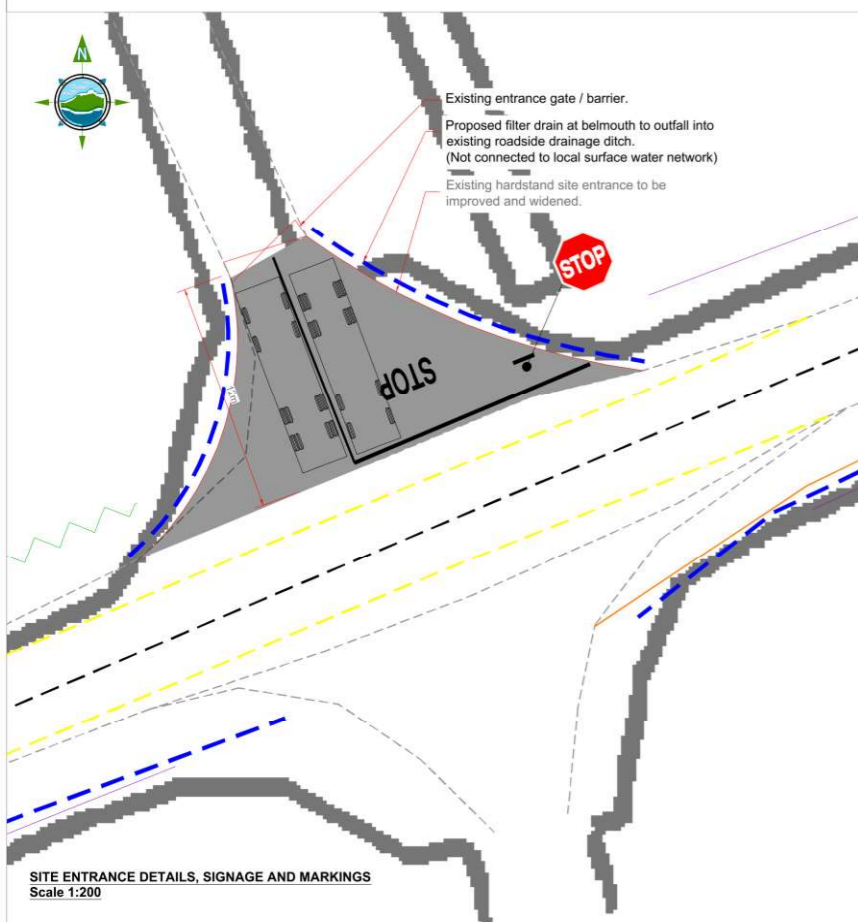

Rev	Date	Description	By	Chkd.

Client: **COILLTE**

Project: **CASTLEBANNY WIND FARM**

Title: **SITE ENTRANCE IMPROVEMENT WORKS & AUTOTRACK ASSESSMENT R704**

Scale @ A1: **As Shown**

Prepared by: **M. Nolan** Checked: **J. Staunton** June 2020

Project Director:

Drawing Status: **Information**

TOBIN
CONSULTING ENGINEERS

Block 10-4, Blanchardstown Corporate Park,
Dublin 15, Ireland.
tel: +353-(0)1-8030406
fax: +353-(0)1-8030409
e-mail: dublin@tobin.ie
www.tobin.ie

Tobin Consulting Engineers will not be liable for any use of this document for any purpose other than that for which it was specifically prepared. The user must ensure that the user has the necessary permissions to use the information contained in this document. The user must ensure that the user has the necessary permissions to use the information contained in this document. The user must ensure that the user has the necessary permissions to use the information contained in this document.

Drawing No.: **10730-2052 D01** Revision:

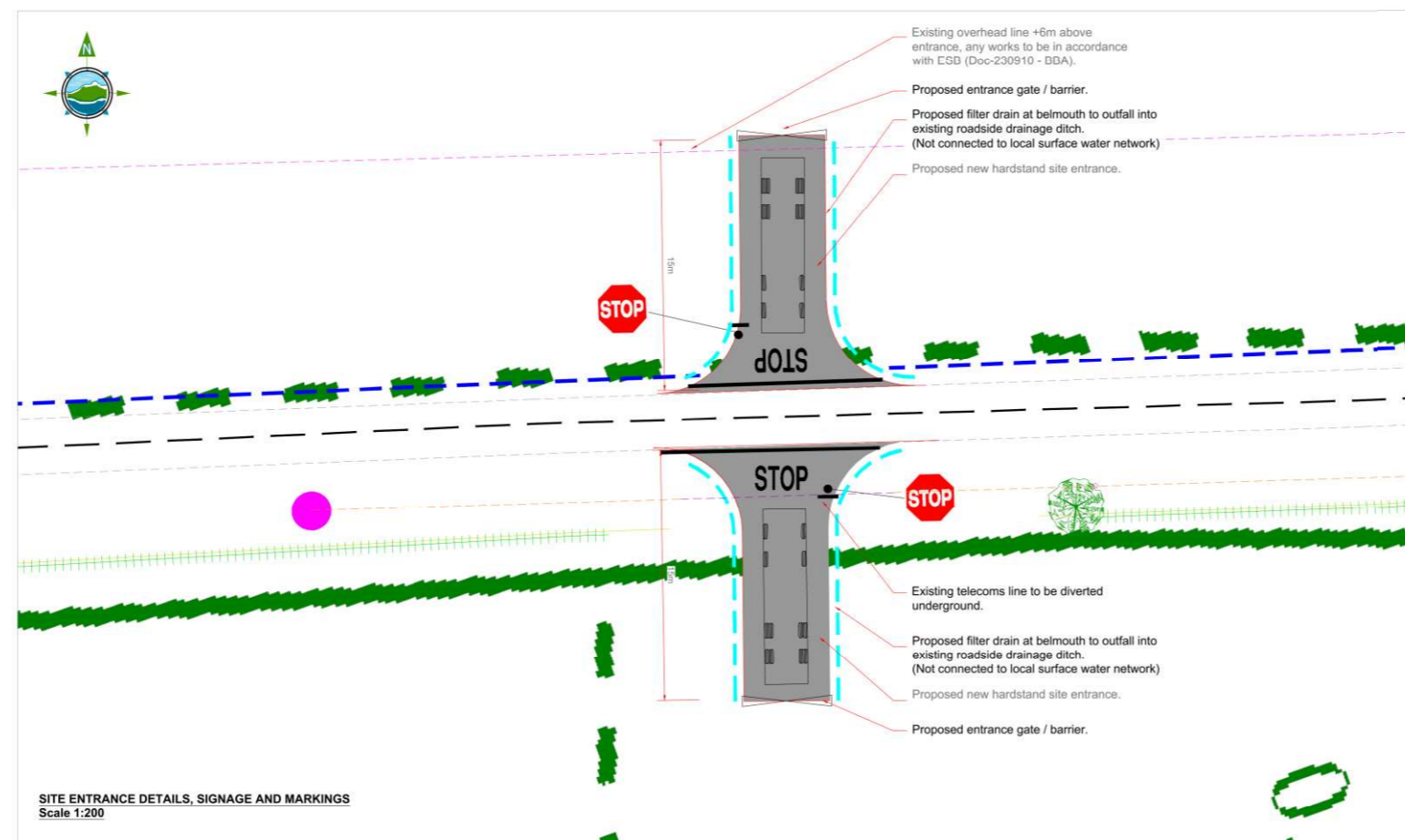
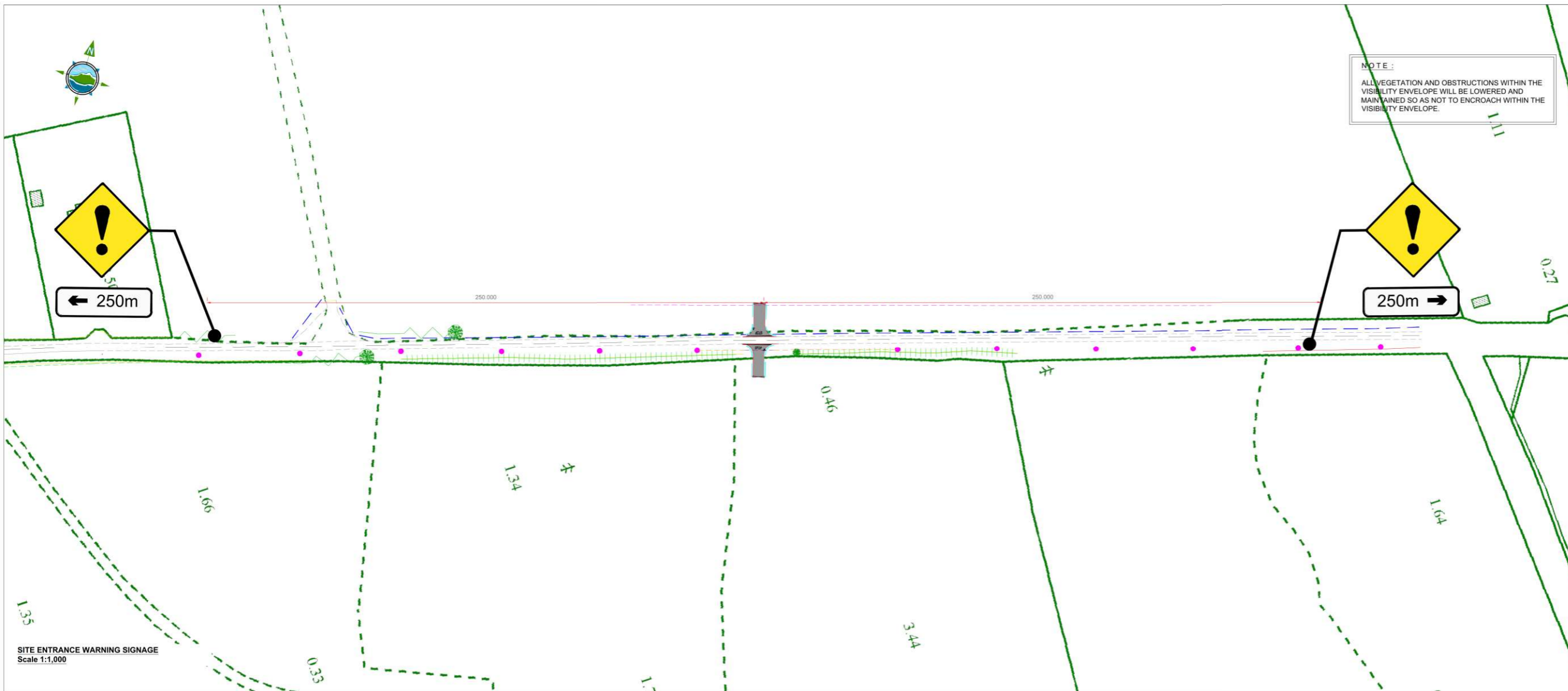

Rev	Date	Description	By	Chkd.

Client: 
COILLTE

Project:
CASTLEBANNY WIND FARM

Title:
SITE ENTRANCE IMPROVEMENT WORKS
L7451

Scale @ A1: As Shown
Prepared by: M. Nolan
Checked: J. Staunton June 2020
Project Director:
Drawing Status: Information

TOBIN
CONSULTING ENGINEERS

Block 10-4, Blanchardstown Corporate Park,
Dublin 15, Ireland.
tel: +353-(0)1-8030406
fax: +353-(0)1-8030409
e-mail: dublin@tobin.ie
www.tobin.ie

Tobin Consulting Engineers will not be liable for any use of this document for any purpose other than that for which it was originally prepared. Copyright, in copyright, and liability are retained by Tobin Consulting Engineers. No copyright notice is present in this document may be reproduced or transmitted in any form and this document shall not be relied upon by any third party for any purpose.

Drawing No.: 10730-2053 D01

SAFETY AUDIT FEEDBACK FORM

Scheme: Proposed Wind Farm at Castlebanny, Co. Kilkenny

Document Number: 20120-01-001

Audit Stage: Stage 1/2

Date Audit Completed: 25th November 2020

Paragraph No. in Safety Audit Report	To Be Completed By Designer			To Be Completed by Audit Team Leader
	Problem accepted (yes/no)	Recommended measure accepted (yes/no)	Describe alternative measure(s). Give reasons for not accepting recommended measure. Only complete if recommended measure is not accepted.	Alternative measures or reasons accepted by auditors (yes/no)
2.1	Yes	Yes	_____	_____
2.2	Yes	Yes	_____	_____
2.3	Yes	Yes	_____	_____
2.4	Yes	Yes	_____	_____

Safety Audit

Signed off ...  Design Team Leader

Print NameJohn Staunton.....

Date 7th Dec 2020

Safety Audit

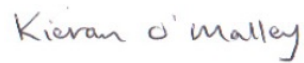
Signed off  Employer

Print NameKieran O'Malley....

Date 9th Dec 2020

Safety Audit Signed off  Audit Team Leader

Print NameGEORGE FRISBY.....

Date14/12/2020.....

Please complete and return to: Roadplan Consulting Ltd.
7, Ormonde Road
Kilkenny
E-mail: info@roadplan.ie